

# SBC-2 250

## GENERAL DATA

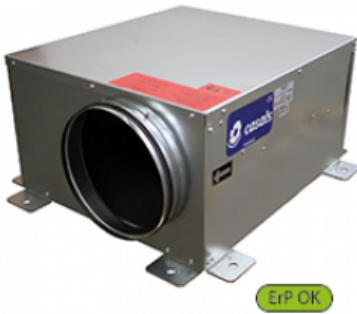

### CENTRIFUGAL LOW PROFILE BOX WITH CIRCULAR FLANGES. EXTERNAL ROTOR MOTOR

#### CONSTRUCTIVE FEATURES:

- Box manufactured in galvanized sheet with thermo-acoustic insulation, Bs1d0 fire class
- Circular connection flanges
- Asynchronous external rotor, which includes thermal protector and ball bearings permanently greased. IP-44 protection and insulation class B according to DIN 40.050 h1. Standard voltage 230V 60Hz

#### APPLICATIONS:

- Designed for inline installation, they are suitable for:
- Air renewal in bathrooms and small premises.
  - Perfect for installing in false ceilings or open.
  - Maximum working temperature: 50°C.

## PERFORMANCE CURVE

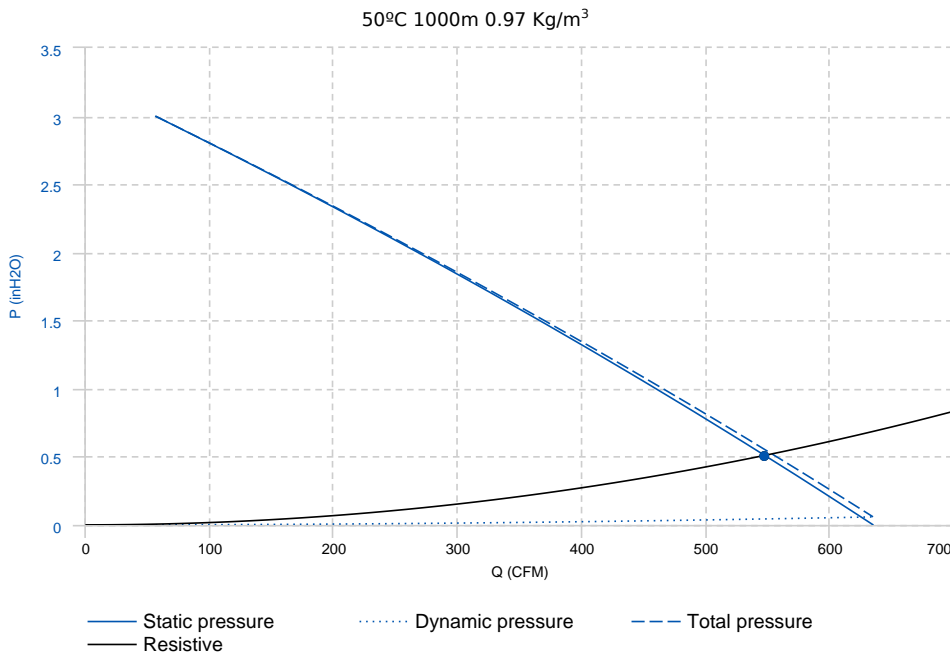

Design point	
Flow (CFM)	547.15
Pressure (inH2O)	0.51
Service point	
T.max (°C)	50
Q (CFM)	547.13
Ps (inH2O)	0.51
Pd (inH2O)	0.05
Pt (inH2O)	0.56
Speed (m/s)	5.26
Pabs (kW) 1.2 Kg/m <sup>3</sup>	0.38

## TECHNICAL DATA

Fan					
RPM	3040	Approx. weight	17.5 kg	Max. Flow	635.66 CFM

Motor							
Power	0,19 kW	RPM	2450	Capacitor	6	I max. (230V)	0,82 A
Approx. weight	3.5 kg						

## ACOUSTIC DATA

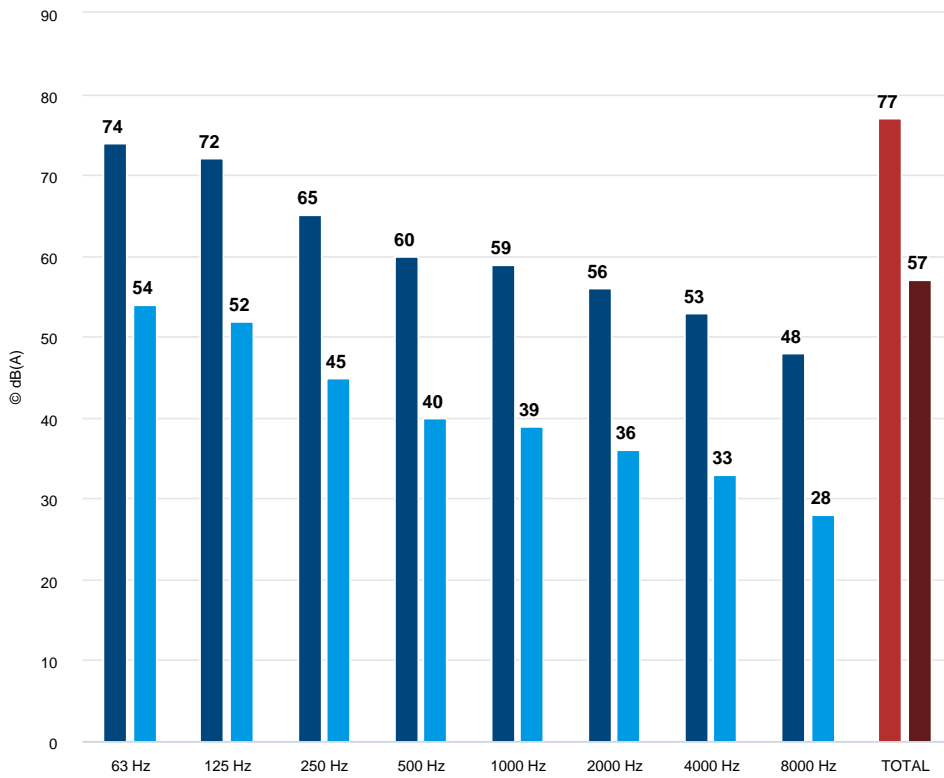

Sound power	
63 Hz	74
125 Hz	72
250 Hz	65
500 Hz	60
1000 Hz	59
2000 Hz	56
4000 Hz	53
8000 Hz	48
TOTAL	77

Sound pressure 3m (in)	
63 Hz	54
125 Hz	52
250 Hz	45
500 Hz	40
1000 Hz	39
2000 Hz	36
4000 Hz	33
8000 Hz	28
TOTAL	57

## DIMENSIONS

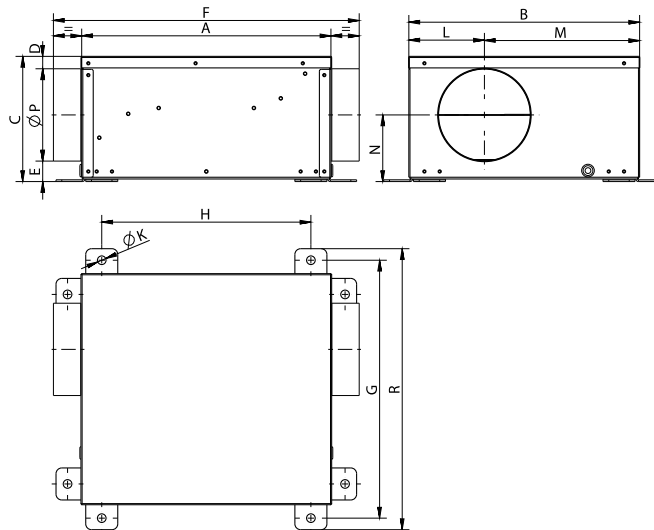

Dimensions (mm)

A	567	B	497	C	305,5	D	23	E	32.5
F(aprox)	685	G	554	H	467,5	L	176	M	321
N	157.5	R	604	ØK	15	ØP	250		

**WIRING DIAGRAM**

